

EXISTING INMATE CAPACITY	NEW INMATE CAPACITY
MEN	MEN
12 BED DORM (1) 12	8 BED CELL (6) 48
8 BED DORM (7) 56	2 BED CELL (1) 2
	1 BED CELL (1) 1
TOTAL MEN 68 BEDS	TOTAL MEN 51 BEDS
WOMEN	WOMEN
6 BED CELL (1) 6	6 BED CELL (1) 6
4 BED CELL (1) 4	4 BED CELL (1) 4
2 BED CELL (1) 2	2 BED CELL (1) 2
TOTAL WOMEN 12 BEDS	TOTAL WOMEN 12 BEDS
SEP. CELLS	SEP. CELLS
SINGLE CELLS (7) 7	SINGLE CELLS (7) 7
TOTAL SINGLE 7 BEDS	TOTAL SINGLE 7 BEDS
	VIOLENT CELLS
	2 VIOLENT CELLS
TOTAL EXISTING CAPACITY = 87 BEDS	TOTAL NEW CAPACITY = 70 BEDS

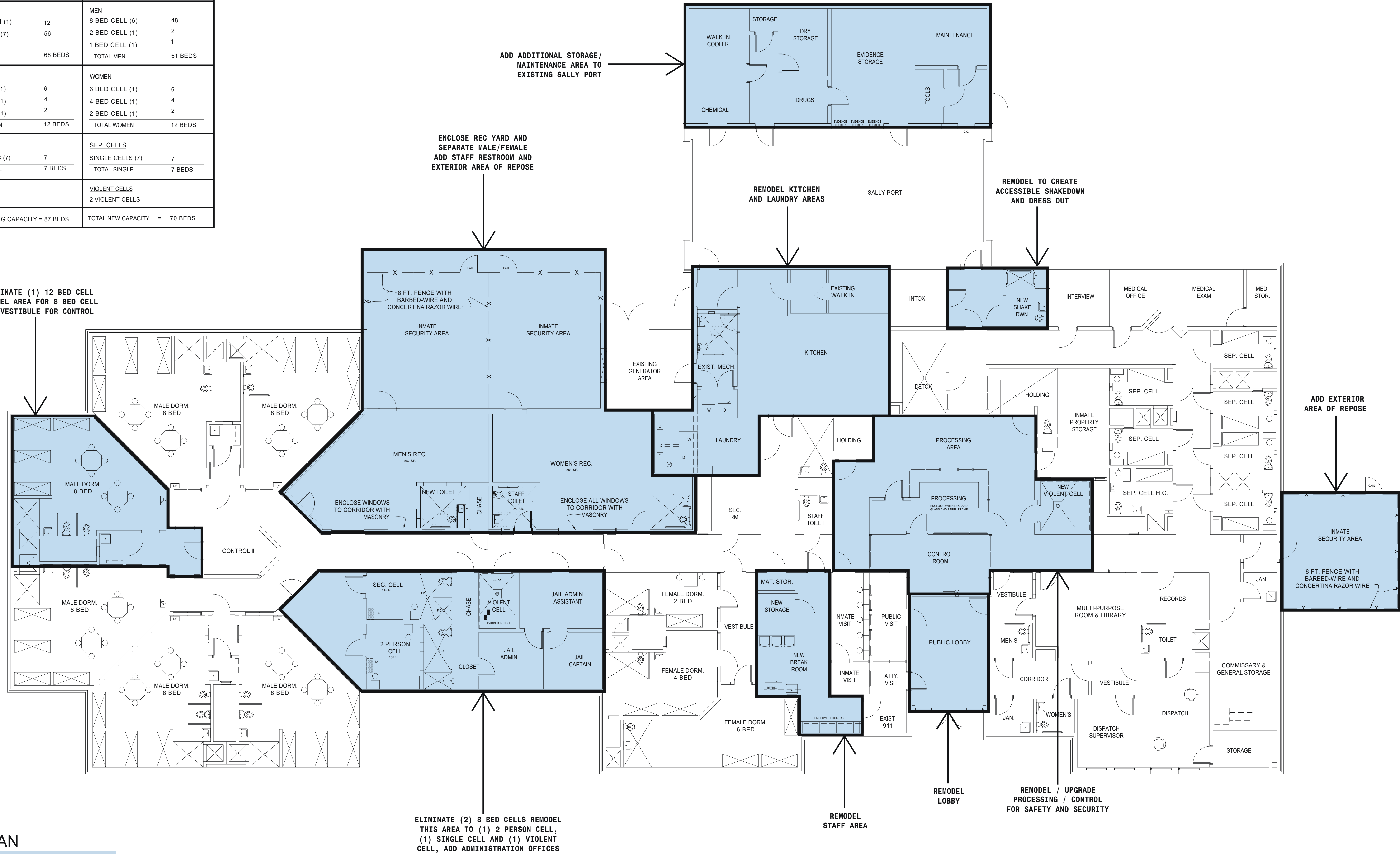

FLOOR PLAN

1/8" = 1'-0"  
0 8'-0"

RUNNELS COUNTY JAIL  
REMODEL & UPGRADES